

**US Army Corps of Engineers**  
 San Francisco District  
 1455 Market Street  
 San Francisco, CA 94103

**DISCLAIMER**  
 Distribution Liability: The data represents the results of data collection/processing for a specific US Army Corps of Engineers activity and indicates the general existing conditions. The user is responsible for the results of any of the application of the data for other than its intended purpose.  
 Access Constraints: The United States Government furnishes this information and the data furnished. The United States shall be under no liability whatsoever to any person by reason of any use made hereof. These data belong to the Government. Therefore the recipient may not transfer these data to others without also transferring this Disclaimer.

Prepared Under the Direction of <b>JOHN D. CUNNINGHAM</b> LT COLONEL, C.E. DISTRICT ENGINEER	Chart Date: Apr 14, 2020
Submitted: Hydro Survey Team Leader	Designed by: PDT
Recommended: Chief, Hydro Survey Section	Checked By: PDT
Approved: Chief, Construction Branch	Drawn by: PDT

CENTERLINE ∠	EAST	NORTH
C1	6028432.2184	2082797.0402
C2	6039090.2184	2054839.0402

CHANNEL ∠	EAST	NORTH
1	6028665.8184	2082886.0402
2	6039323.8184	2054933.0402
3	6038856.6184	2054749.9402
4	6028198.6184	2082707.9402

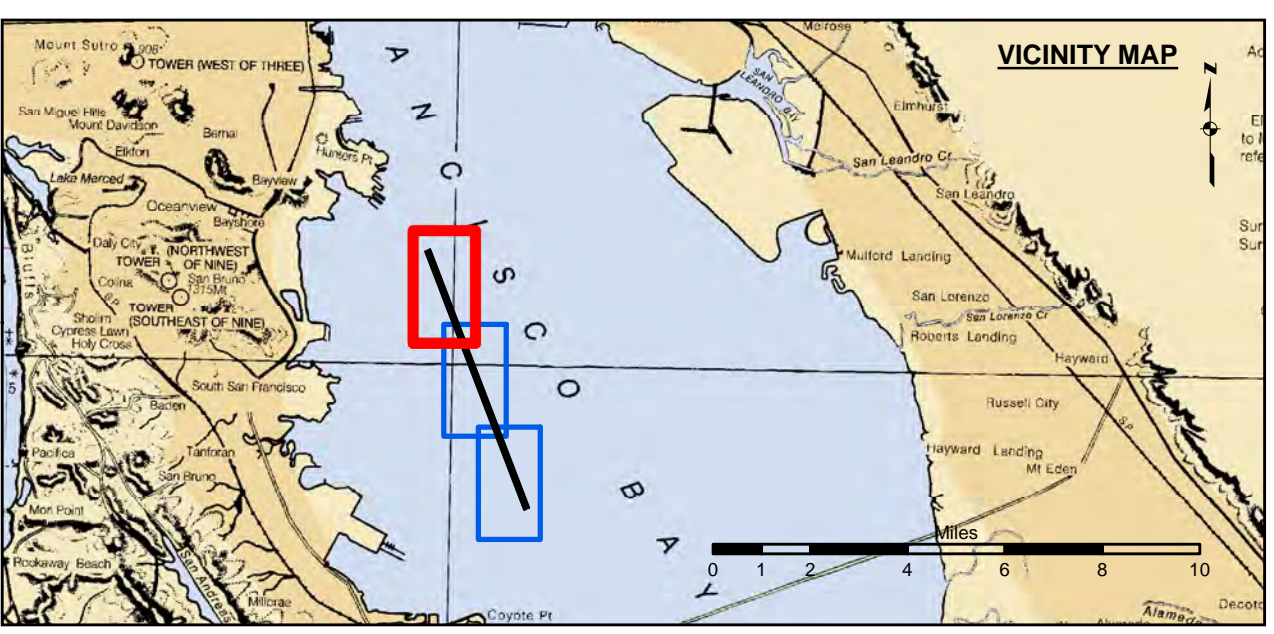
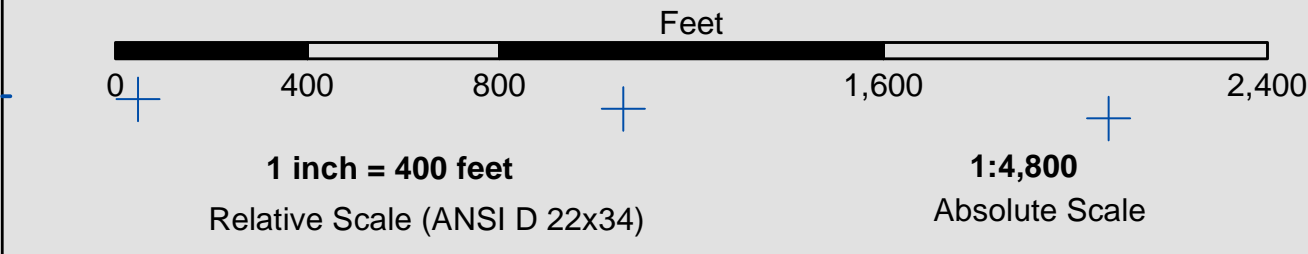

Federal Navigation Channel	Beacon, General	<b>Contours</b>
Shoaling Area	Obstruction Point	-30
Placement Area	Navigation Buoy	-29
Anchorage Area	Navigation Buoy	-28
Wreck Area	Shoalest Sounding*	-27
Submerged Wreck		-26
Angle Point		

**NOTES:**  
 DRAWING NOT TO BE USED FOR NAVIGATION. ONLY CHANNEL CONDITION AT DATE OF SURVEY.  
 THE LOCATION OF ALL NAVIGATION AIDS ARE BASED ON INFORMATION PROVIDED BY THE U.S. COAST GUARD. BUOY LOCATIONS REPRESENT THE POSITION OF THE SINKER ONLY.  
 INFORMATION DEPICTED ON THIS MAP REPRESENTS THE RESULTS OF SURVEYS MADE ON THE DATES INDICATED AND CAN ONLY BE CONSIDERED AS INDICATING THE GENERAL CONDITIONS AT THAT TIME.  
 SURVEYED BY THE CORPS OF ENGINEERS.  
 \*SHOALEST SOUNDING PER QUARTER PER REACH

SOUNDINGS WERE TAKEN BY FATHOMETER AND ARE SHOWN TO THE NEAREST TENTH OF A FOOT.  
 SOUNDINGS ARE BASED ON THE DATUM OF MEAN LOWER LOW WATER AT THE LOCALITY.  
 PLANE GRID, BEARING AND COORDINATES ARE BASED ON THE STATE OF CALIFORNIA COORDINATE SYSTEM, LAMBERT CONFORMAL PROJECTION, ZONE III NAD 83, CALIFORNIA, AS DESCRIBED IN SPECIAL PUBLICATION NO. 253, PUBLISHED BY NATIONAL OCEAN SURVEY.  
 THE PROJECT DEPTH IS 30 FEET AT M.L.L.W.  
 CONTROL: SOUNDINGS ARE BASED ON THE TIDE GAUGE LOCATED AT THE HYDE STREET PIER, SAN FRANCISCO, CALIFORNIA.  
 CONTROL:  
 NOAA 941 4358  
 BM 'S 1941': 15.74 FT MLLW  
 HUNTERS POINT TIDE GAUGE: 13 FT MLLW  
 NAIL AND BRASS WASHER (ORANGE RIBBON ATTACHED) ON PILING AT SE CORNER OF PIER 80  
 NAIL LEVELED BY USACE ON 14 FEBRUARY 2016.  
 HORIZONTAL COORDINATES: POST PROCESSED RTK FROM LOCAL REFERENCE STATIONS

CALIFORNIA  
 SAN MATEO COUNTY  
**SAN BRUNO SHOAL**  
 CONDITION SURVEY  
 09 APRIL 2020

**Sheet Reference Number**  
 1 of 3



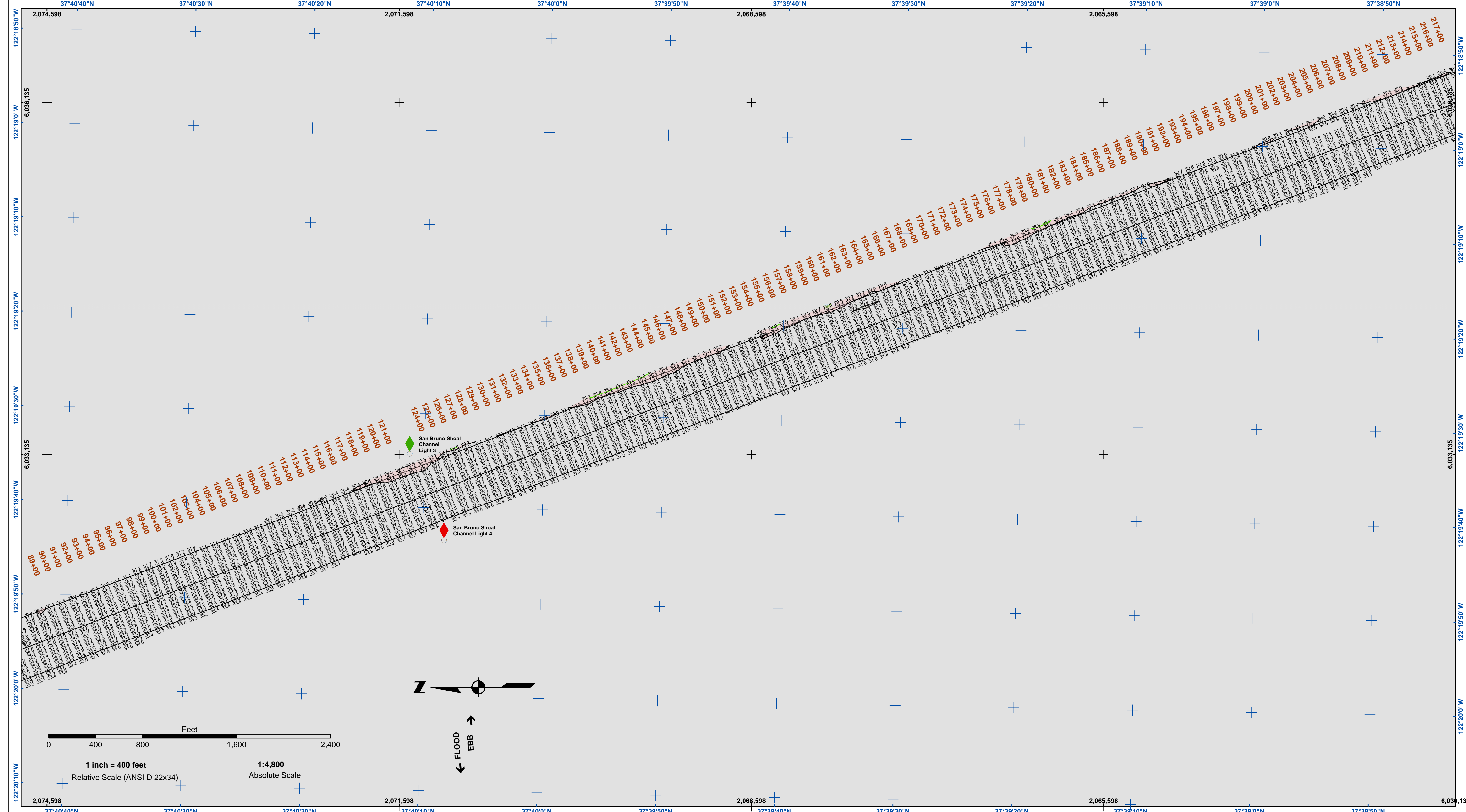

**US Army Corps of Engineers**  
 San Francisco District  
 1455 Market Street  
 San Francisco, CA 94103

**DISCLAIMER**  
 The United States Government furnishes this information as a service to the public and does not warrant, express or implied, the accuracy, completeness, or reliability of the information and the data furnished. The United States shall be under no liability whatsoever to any person by reason of any use made hereof. These data belong to the Government. Therefore the recipient may not transfer these data to others without also transferring this Disclaimer.

Prepared Under the Direction of <b>JOHN D. CUNNINGHAM</b> LT COLONEL, C.E., DISTRICT ENGINEER	Chart Date: Apr 14, 2020
Submitted: Hydro Survey Team Leader	Designed by: PDT
Recommended: Chief, Hydro Survey Section	Drawn by: PDT
Approved: Chief, Construction Branch	

CALIFORNIA  
 SAN MATEO COUNTY  
**SAN BRUNO SHOAL**  
 CONDITION SURVEY  
 09 APRIL 2020

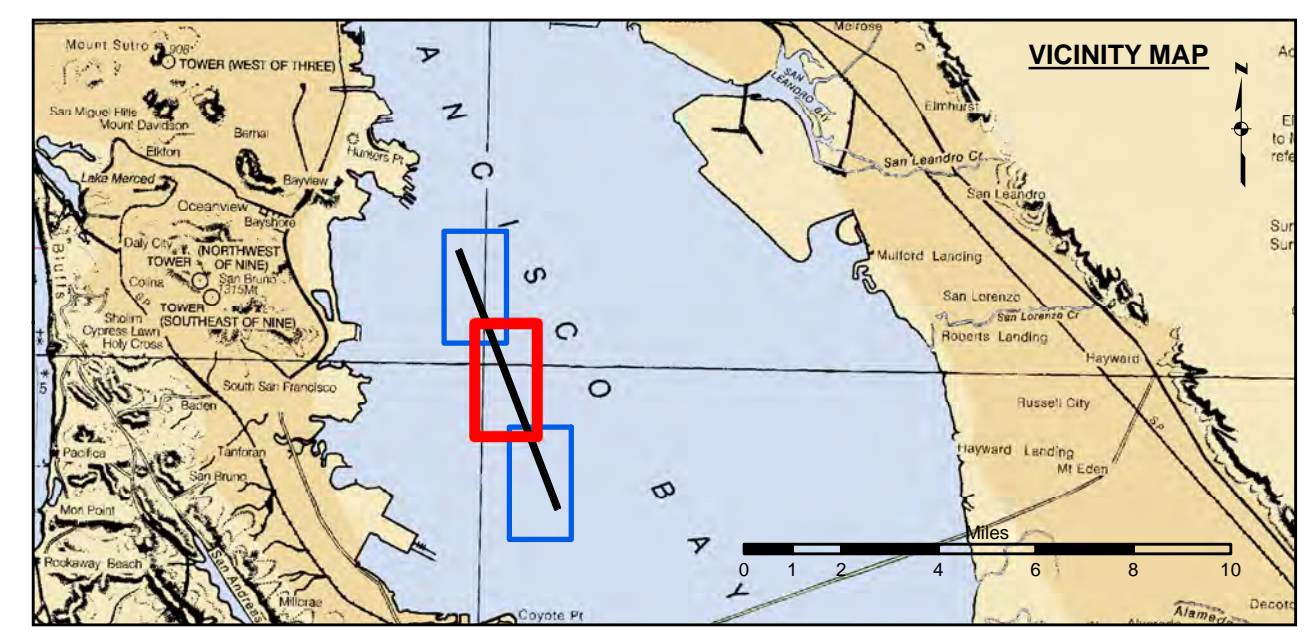

Federal Navigation Channel	Beacon, General	<b>Contours</b>
Shoaling Area	Obstruction Point	
Placement Area	Navigation Buoy	
Anchorage Area	Navigation Buoy	
Wreck Area	Shoalest Sounding*	
Submerged Wreck		-30
Angle Point		-29
		-28
		-27
		-26

**NOTES:**  
 DRAWING NOT TO BE USED FOR NAVIGATION. ONLY CHANNEL CONDITION AT DATE OF SURVEY.  
 THE LOCATION OF ALL NAVIGATION AIDS ARE BASED ON INFORMATION PROVIDED BY THE U.S. COAST GUARD. BUOY LOCATIONS REPRESENT THE POSITION OF THE SINKER ONLY.  
 INFORMATION DEPICTED ON THIS MAP REPRESENTS THE RESULTS OF SURVEYS MADE ON THE DATES INDICATED AND CAN ONLY BE CONSIDERED AS INDICATING THE GENERAL CONDITIONS AT THAT TIME.  
 SURVEYED BY THE CORPS OF ENGINEERS.  
 CONTROL: SOUNDINGS ARE BASED ON THE TIDE GAUGE LOCATED AT THE HYDE STREET PIER, SAN FRANCISCO, CALIFORNIA.  
 THE PROJECT DEPTH IS 30 FEET AT M.L.L.W.  
 CONTROL: NOAA 941 4358  
 BM 'S 1941': 15.74 FT MLLW  
 HUNTERS POINT TIDE GAUGE: 13 FT MLLW  
 NAIL AND BRASS WASHER (ORANGE RIBBON ATTACHED) ON PILING AT SE CORNER OF PIER 80 NAIL LEVELLED BY USACE ON 14 FEBRUARY 2016.  
 HORIZONTAL COORDINATES: POST PROCESSED RTK FROM LOCAL REFERENCE STATIONS

**Sheet Reference Number**  
 2 of 3



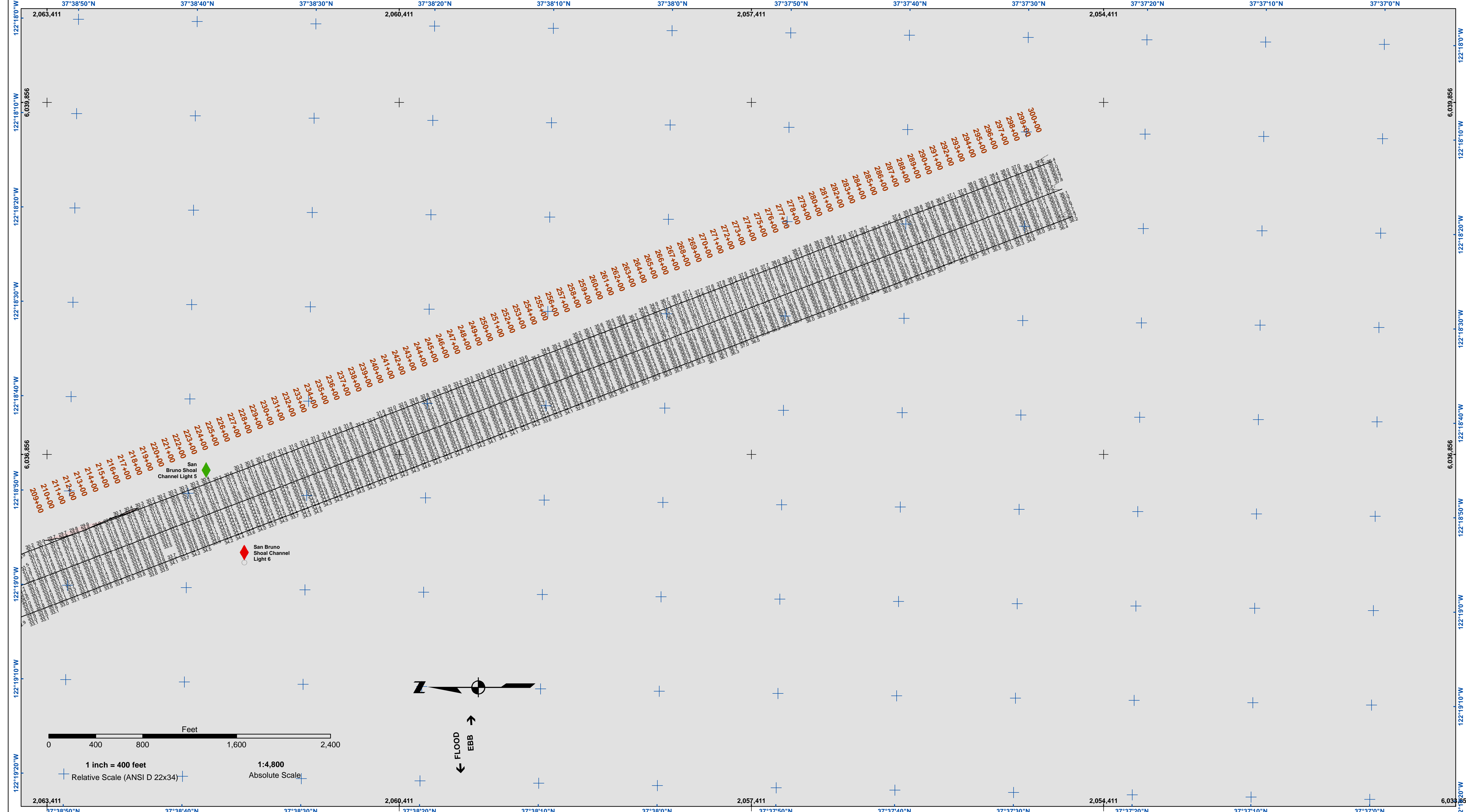

**US Army Corps of Engineers**  
 San Francisco District  
 1455 Market Street  
 San Francisco, CA 94103

**DISCLAIMER**  
 The United States Government furnishes this information as a service to the public and does not warrant, express or implied, the accuracy, completeness, or reliability of the information and the data furnished. The United States shall be under no liability whatsoever to any person by reason of any use made hereof. These data belong to the Government. Therefore the recipient may not transfer these data to others without also transferring this disclaimer.

Prepared Under the Direction of <b>JOHN D. CUNNINGHAM</b> LT COLONEL, C.E. DISTRICT ENGINEER	Chart Date: Apr 14, 2020
Submitted: Hydro Survey Team Leader	Designed by: PDT
Recommended by: Chief, Hydro Survey Section	Checked by: PDT
Approved: Chief, Construction Branch	Drawn by: PDT

CALIFORNIA  
 SAN MATEO COUNTY  
**SAN BRUNO SHOAL**  
 CONDITION SURVEY  
 09 APRIL 2020

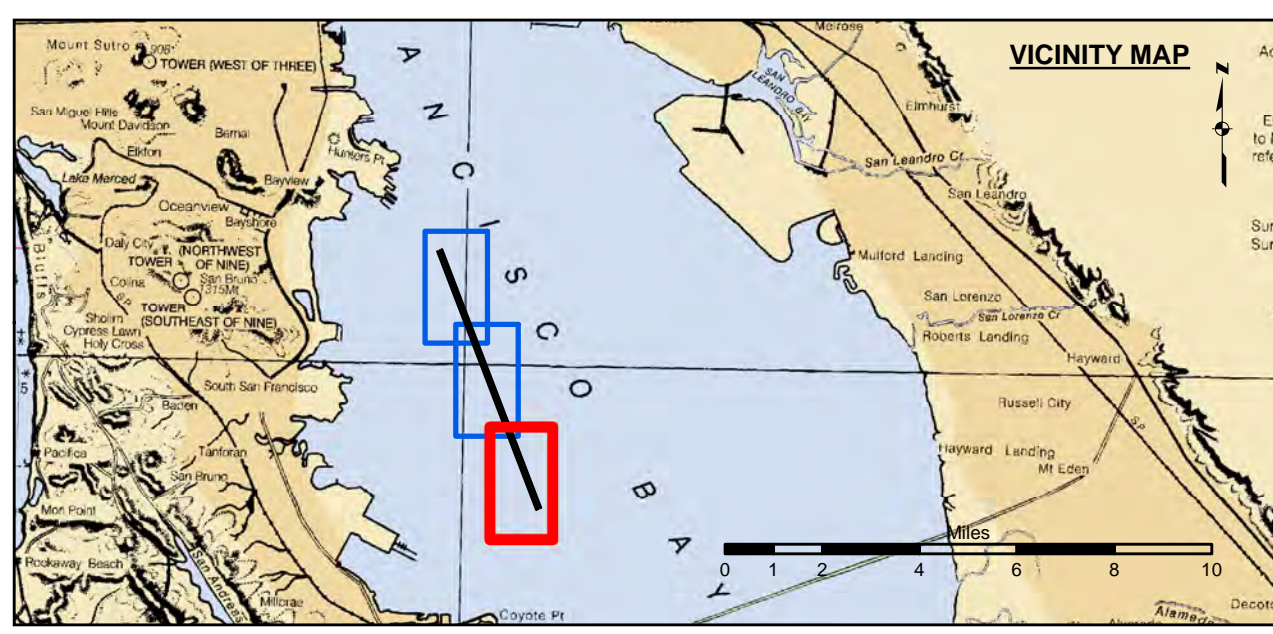

Federal Navigation Channel	Beacon, General	<b>Contours</b>
Shoaling Area	Navigation Buoy	-30
Placement Area	Navigation Buoy	-29
Anchorage Area	Shoalest Sounding*	-28
Wreck Area		-27
Submerged Wreck		-26
Angle Point		

**NOTES:**  
 DRAWING NOT TO BE USED FOR NAVIGATION. ONLY CHANNEL CONDITION AT DATE OF SURVEY.  
 THE LOCATION OF ALL NAVIGATION AIDS ARE BASED ON INFORMATION PROVIDED BY THE U.S. COAST GUARD. BUOY LOCATIONS REPRESENT THE POSITION OF THE SINKER ONLY.  
 INFORMATION DEPICTED ON THIS MAP REPRESENTS THE RESULTS OF SURVEYS MADE ON THE DATES INDICATED AND CAN ONLY BE CONSIDERED AS INDICATING THE GENERAL CONDITIONS AT THAT TIME.  
 SURVEYED BY THE CORPS OF ENGINEERS.  
 \*SHOALEST SOUNDING PER QUARTER PER REACH

SOUNDINGS WERE TAKEN BY FATHOMETER AND ARE SHOWN TO THE NEAREST TENTH OF A FOOT.  
 SOUNDINGS ARE BASED ON THE DATUM OF MEAN LOWER LOW WATER AT THE LOCALITY.  
 PLANE GRID, BEARING AND COORDINATES ARE BASED ON THE STATE OF CALIFORNIA COORDINATE SYSTEM, LAMBERT CONFORMAL PROJECTION, ZONE III NAD 83, CALIFORNIA, AS DESCRIBED IN SPECIAL PUBLICATION NO. 253, PUBLISHED BY NATIONAL OCEAN SURVEY.  
 THE PROJECT DEPTH IS 30 FEET AT M.L.L.W.  
 CONTROL: SOUNDINGS ARE BASED ON THE TIDE GAUGE LOCATED AT THE HYDE STREET PIER, SAN FRANCISCO, CALIFORNIA.  
 CONTROL:  
 NOAA 941 4358  
 BM 'S 1941': 15.74 FT MLLW  
 HUNTERS POINT TIDE GAUGE: 13 FT MLLW  
 NAIL AND BRASS WASHER (ORANGE RIBBON ATTACHED) ON PILING AT SE CORNER OF PIER 80 NAIL LEVELED BY USACE ON 14 FEBRUARY 2016.  
 HORIZONTAL COORDINATES: POST PROCESSED RTK FROM LOCAL REFERENCE STATIONS

**Sheet Reference Number**  
**3 of 3**